

AUSTRALIAN

HOUSE & GARDEN

More *Luxe* Outdoor Living

Styling alfresco
PLANTS AND
PIECES TO BUY

LET'S GO OUTSIDE

Design ideas for
the great outdoors



9 313006 026488

SECRET GARDEN

A CONVERTED BAKERY AND WAREHOUSE FEATURES A SURPRISE GREEN SPACE THAT OFFERS ITS OWNERS SERENITY IN SYDNEY'S BUZZING INNER WEST.

STORY *Rhiannon Lidbury* PHOTOGRAPHY *Anson Smart*

INNER WEST, SYDNEY

INDOOR DINING The home's room is the perfect spot to take garden, designed by Asher Cole Social. An expansive dining second-hand find by the owner by Bentwood chairs from Lawson



What was once an old bakery and warehouse in Sydney's trendy inner west has been reborn as a distinctive residential space, grounded by its whimsical central garden. In a collaboration between interior designer Anna-Carin and landscape architect Asher Cole from The Garden Social, the home's nuanced history is elevated in the rambling outdoor space. "This courtyard space was like an empty gallery, looked at from every angle and the central piece of the home," says Asher. "When you entered, you were so aware of the rich layered history, and this really needed to be respected and highlighted." Wanting a nature-led garden, the owners requested for the visual impact of the space to be prioritised over its functionality. "We love the way the planting has taken over the courtyard," says Asher. "This creates such an impactful sense of calm for the centre of the home and is a great example of the role a well-planted courtyard can play." Three 40-year-old olive trees from Queensland were craned in to build the mature garden and foster a sense of intimacy. "In a densely urban setting, the ability to be fully immersed in a garden of scale and wildness has enormous benefits for our day-to-day lives," says Asher. "We're proud to have created that for our clients."

Design and building team Landscape design The Garden Social; thegardensocial.com.au.
Interior design Anna-Carin Design Studio; annacarindesign.com.au.

"A courtyard overtaken by seasonal planting allowed us to rival the age of the building and come back to this core sense of time."

Asher Cole, landscape architect

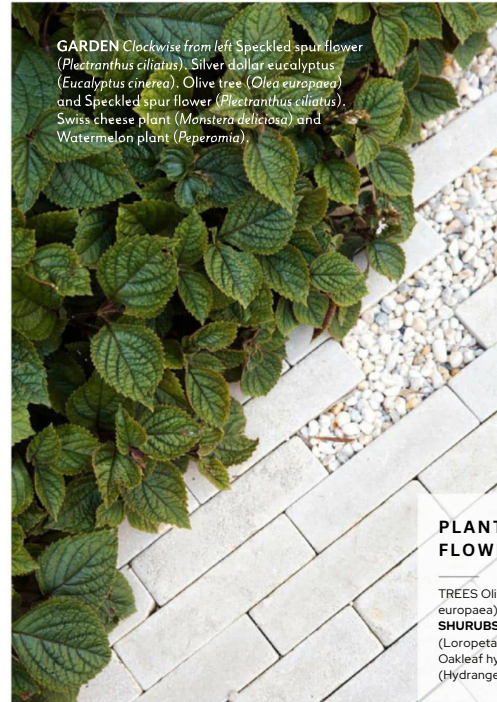

GARDEN Clockwise from left Speckled spur flower (*Plectranthus ciliatus*), Silver dollar eucalyptus (*Eucalyptus cinerea*), Olive tree (*Olea europaea*) and Speckled spur flower (*Plectranthus ciliatus*), Swiss cheese plant (*Monstera deliciosa*) and Watermelon plant (*Peperomia*).



PLANTS & FLOWERS

TREES Olive tree (*Olea europaea*).

SHURUBS Pink fringe flower (*Loropetalum chinense*)
 Oakleaf hydrangea (*Hydrangea quercifolia*).

SUCCULENTS Pensulous Yucca (*Yucca recurvifolia*).

GROUND COVERS Speckled spur flower (*Plectranthus ciliatus*), Inch plant (*Tradescantia zebrina*)

GRASS Mat rush (*Lomandra longifolia*), Dwarf maiden grass (*Miscanthus sinensis*)

CLIMBERS Boston ivy (*Parthenocissus tricuspidata*).

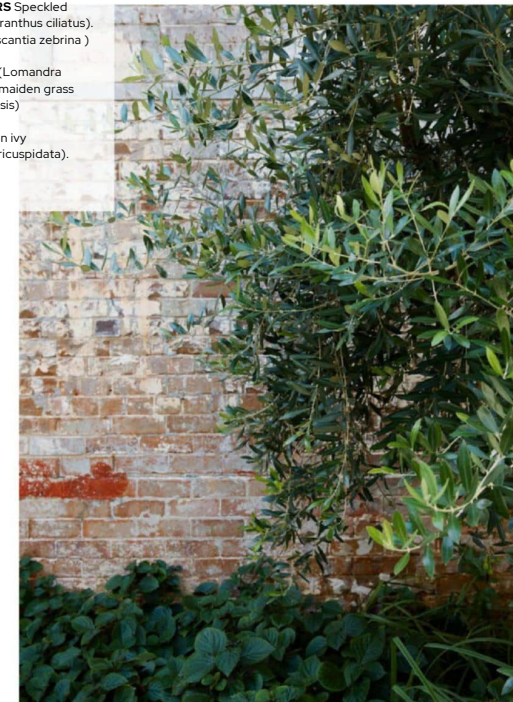

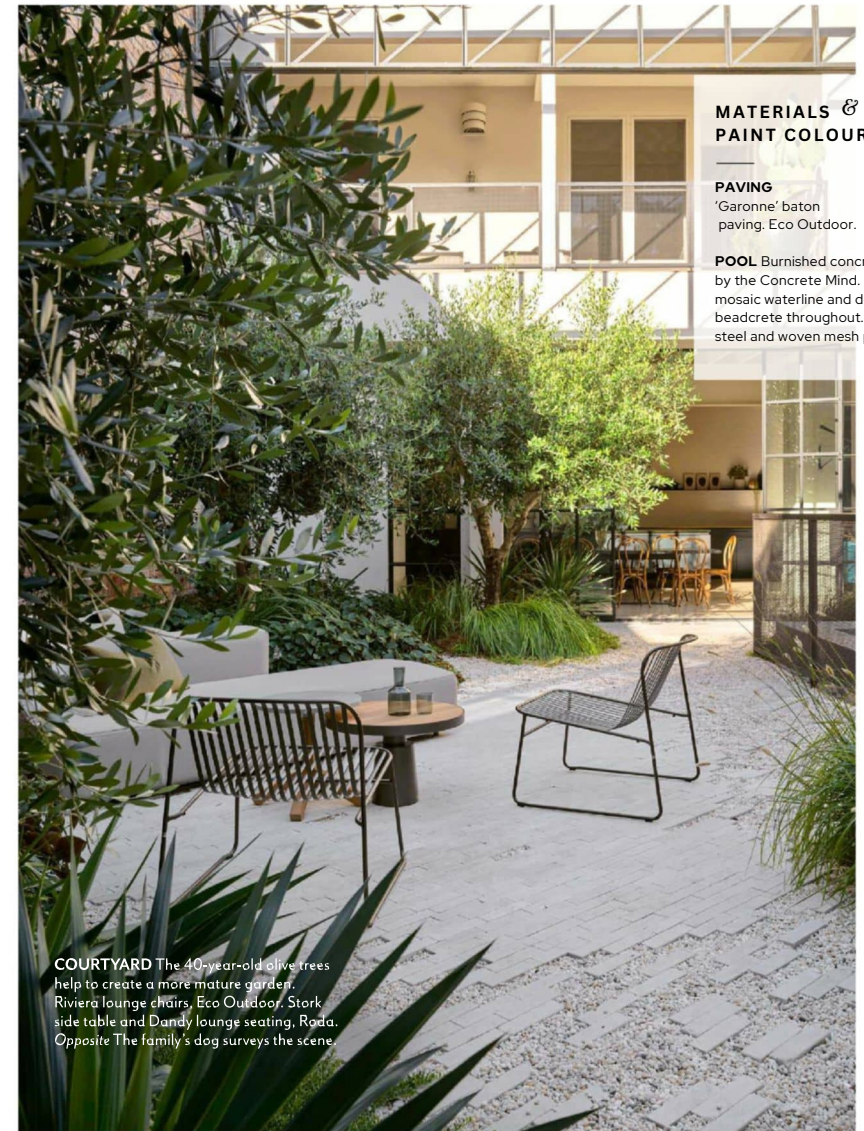

MATERIALS & PAINT COLOURS

PAVING
'Garonne' baton paving, Eco Outdoor.

POOL Burnished concrete by the Concrete Mind. Ceramic mosaic waterline and designer beadcrete throughout. Custom steel and woven mesh pool fence.

COURTYARD The 40-year-old olive trees help to create a more mature garden. Riviera lounge chairs, Eco Outdoor. Stork side table and Dandy lounge seating, Roda. Opposite The family's dog surveys the scene.



“In a densely urban setting, the ability to be fully immersed in a garden of scale and wildness has enormous benefits for our day-to-day lives.”

Asher Cole, landscape architect



OUTDOOR DESIGN NOTES

OUTDOOR CHAIRS Riviera lounge chair, Eco Outdoor.

SIDE TABLE Stork side table Roda.

LIGHTING Hunza exterior lighting installed by MAP Electrical.

DAY BED Custom day bed (beside the pool with cushions in orange fabric).

SHOWER Outdoor shower, Brooklyn Copper Co.

CERAMIC Pots urns and troughs, all garden Life.

COURTYARD The scale dominated the space, so the reducing its size to prioritise t the courtyard. Three 40-year- chosen to help break up the rec the setting. Beside the pool, is with cushions by Adele